

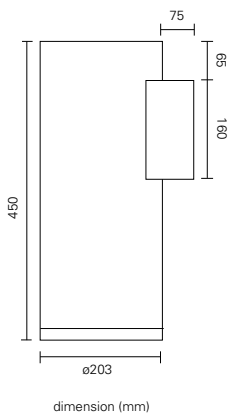

pillar 4



ADVANTAGES

- Architectural stylish appearance
- Easy maintenance, anti corrosion
- Choice of color

APPLICATION

- Building entrance, canopies, subway pedestrian
- Suggested mounting height : 4~6m

FEATURES

- Enclosed luminaire for wall mounting downlight.
- Die cast aluminium sheet.
- Finished with epoxy powder paint. Standard Colour – Black.
- Ballast components mounted on a removable gear tray.
- Anodised finish on aluminium reflector.
- Thermal shock resistant tempered glass.
- Ceramic lamp holder with silver plated contact – Standard G12.

CHARACTERISTICS

- Optical assembly : IP 65
- Ballast Compartment : IP 65
- Electrical Insulation : Class 1
- Voltage : 220V~240V 50/60 Hz
- Wattage : 35W~150W
- Lamp Type : M/H (other lamp available upon request)
- Dimensions (mm) : ø203(L) x 450(H)
- Approx. Net weight : 4~6 kg

HCI-T35W

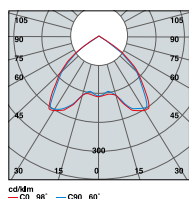

HCI-T35W

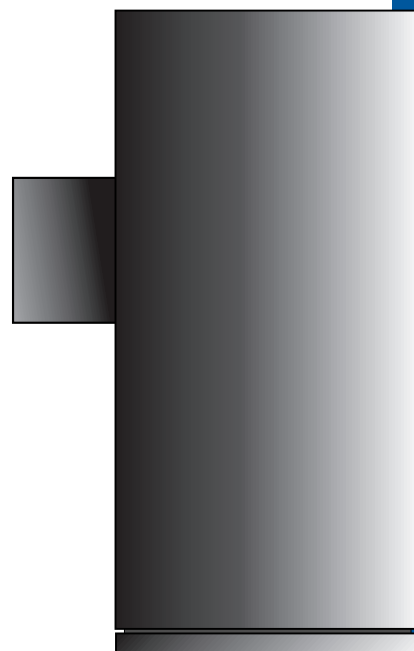
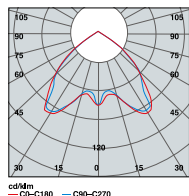

Model No.	Description	Voltage	Frequency	Lamp
GP KP1501	PILLAR 4 35W MH C/W Control Gear & Lamp	220-240V	50-60Hz	G12
GP KP1502	PILLAR 4 70W MH C/W Control Gear & Lamp	220-240V	50-60Hz	G12
GP KP1503	PILLAR 4 150W MH C/W Control Gear & Lamp	220-240V	50-60Hz	G12
GP KP1504	PILLAR 4 35W CDM-R C/W Control Gear & Lamp	220-240V	50-60Hz	E27
GP KP1505	PILLAR 4 70W CDM-R C/W Control Gear & Lamp	220-240V	50-60Hz	E27

ordering information