

dali

ADVANTAGES

- Architectural stylish appearance
- Aluminium and clear tempered glass lens
- High performance and easy maintenance
- Anti Corrosion

APPLICATION

- Streets, pedestrian, parking area
- Security, perimeter, park
- Architectual & landscape
- Suggested mounting height 3~6 meters

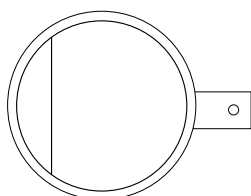
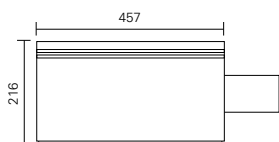
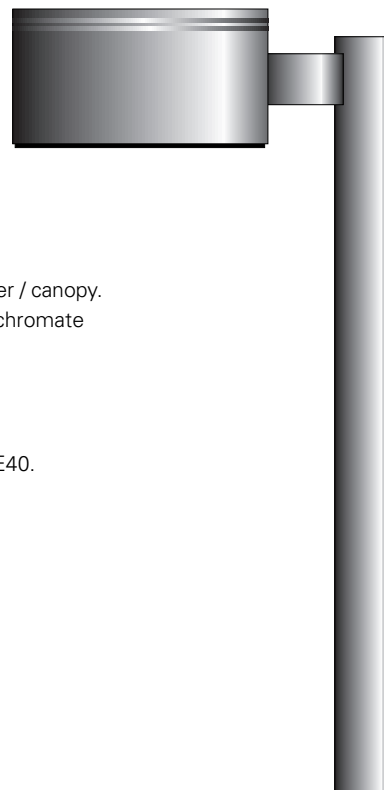

dimension (mm)

FEATURES

- Enclosed luminaire for post mounting.
- Die cast aluminium housing with one piece aluminium cover / canopy.
- Finished with epoxy cationic electro coating and phosphochromate treatment paint. Corrosion resistant.
- Standard colour – Black.
- Ballast compartment mounted on a removable gear tray.
- Light pollution – control louver.
- Lamp holder in ceramic with silver plate contacts – E27 / E40.

CHARACTERISTICS

- Optical/Ballast Compartment : IP 65
- Electrical Insulation : Class I
- Voltage : 220V~240V
- Wattage : 70~400W
- Lamp Type : HPS, M/H or MBF
- Dimensions (mm) : 457(L) x 216(H)
- Approx. Net weight : 10~15 kg

Model No.	Description	Voltage	Frequency	Lamp
GPCP0839	DALI 70W HPS C/W Control Gear & Lamp	220V-240V	50-60Hz	E27
GPCP0840	DALI 150W HPS C/W Control Gear & Lamp	220V-240V	50-60Hz	E40
GPCP0841	DALI 250W HPS C/W Control Gear & Lamp	220V-240V	50-60Hz	E40
GPCP0842	DALI 400W HPS C/W Control Gear & Lamp	220V-240V	50-60Hz	E40
GPCP0843	DALI 70W M/H C/W Control Gear & Lamp	220V-240V	50-60Hz	E27
GPCP0844	DALI 150W M/H C/W Control Gear & Lamp	220V-240V	50-60Hz	E27
GPCP0845	DALI 250W M/H C/W Control Gear & Lamp	220V-240V	50-60Hz	E40
GPCP0846	DALI 400W M/H C/W Control Gear & Lamp	220V-240V	50-60Hz	E40

ordering information